

How to Use The: Clinical Data Checker Problems Report

1. Select the Site Reports tab



2. Right-click on the Clinical-Data Checker Problems Report and open the report in a new tab or window.



3. Export the report into Excel—select export document, choose Excel and select All reports to export

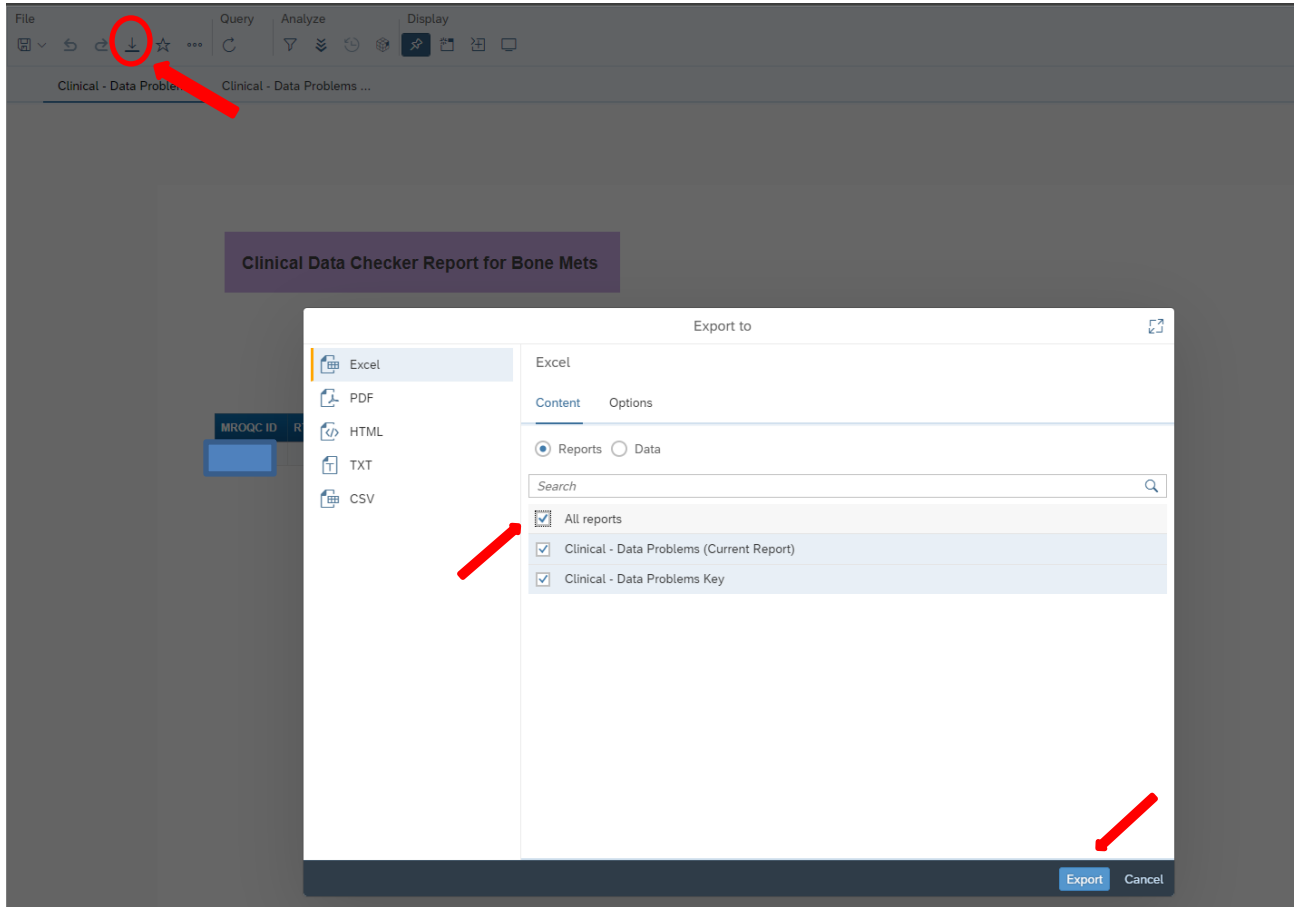

4. The clinical data problems tab will display patients with errors on submitted forms. Each error number is explained on the data problems key.

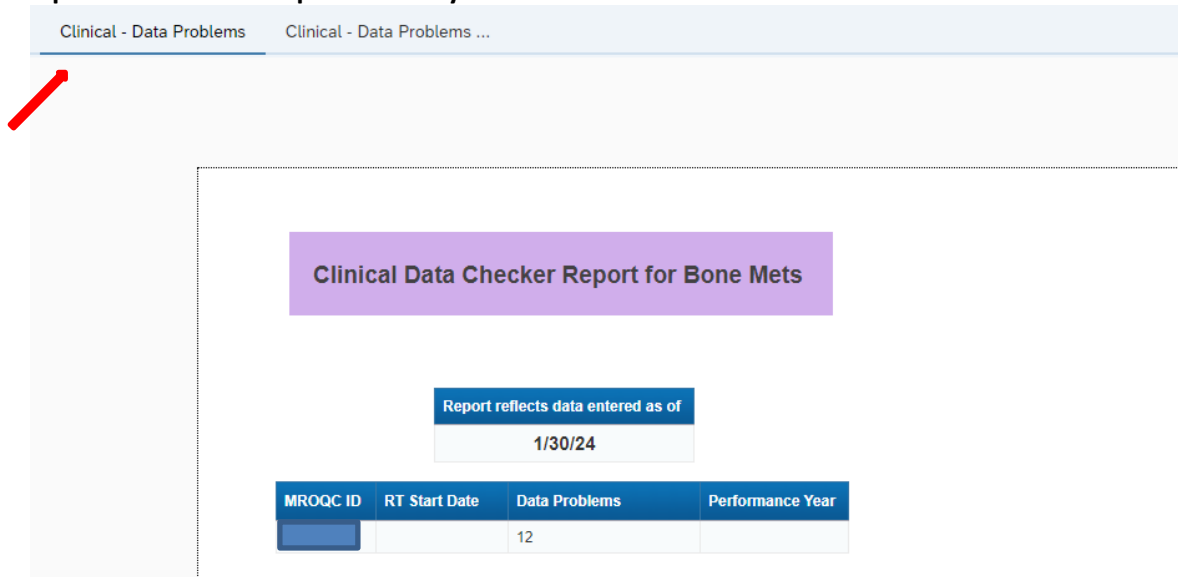

- Select the data problems key tab to display the complete listing of possible errors
- Each number corresponds with a specific data error

Clinical - Data Problems Clinical - Data Problems ...

#	Problem Description
1	On the SE1 form, Please change the patient's status to not eligible if the primary cancer type is not included in the project.
2	On the SE1 form, Please change the patient's exclusion reason to primary cancer type not included in the project
3	Please document the patient's excluded cancer type on the enrollment form SE1
4	On the M1 form, please answer if the patient was inpatient or outpatient at the time of their first fraction.
5	Please add the patient's date of birth on the enrollment form SE1
6	Please add the patient's zip code on the enrollment form SE1
7	Please enter the patient's weight on the M1 form
8	Please add the unit of measure for the patient's weight on the M1 form
9	Please verify the patient's weight submitted on the M1 Form
10	Please verify the patient's initial cancer diagnosis date on the M1 Form. The current date is after the RT start date.
11	Date of First fraction is later than date of Last fraction on the M1 form
12	Please verify the date of initial cancer diagnosis submitted on each of the submitted M1 forms. The date of initial cancer diagnosis should match on all submitted M1 forms.
14	Please correct the hydrocodone dose submitted on the M8 form. The dose field should only include the opioid strength.
16	Please correct the oxycodone dose submitted on the M8 form. The dose field should only include the opioid strength
	For Medication: Fentanvl Buccal: Fentanvl Film or oral sorav: or Fentanvl nasal sorav please change dose unit to mca or mca/hr

Report Information/ Tips

- ✓ Report is refreshed every night
- ✓ Report list problems with specific data points
- ✓ Doesn't include missing forms
- ✓ Print data problems key for easy reference
- ✓ To clear errors, please email support@mroqc-mets.org. The email should include the patient's MROQC ID, the error to clear and the reason why.
- ✓ **Run report at least once per week.**